

# HARVIA

## HARVIA VIRTA 16 KW FLOOR-STANDING SAUNA HEATER CONTROL PANEL VIRTA-160-240



### FEATURES

The Harvia Virta Pro heater provides ample heating power for saunas in spas, hotels and commercial buildings. Thanks to its strong construction, heating elements divided into two groups and exceptionally easy maintenance, the Virta Pro heater is an excellent choice for heavy duty use. The streamlined and stylish heater always provides even the most demanding bathers with a Pro-class sauna experience. Reliable quality by the world's largest sauna heater and stove manufacturer.

### SPECIFICATIONS

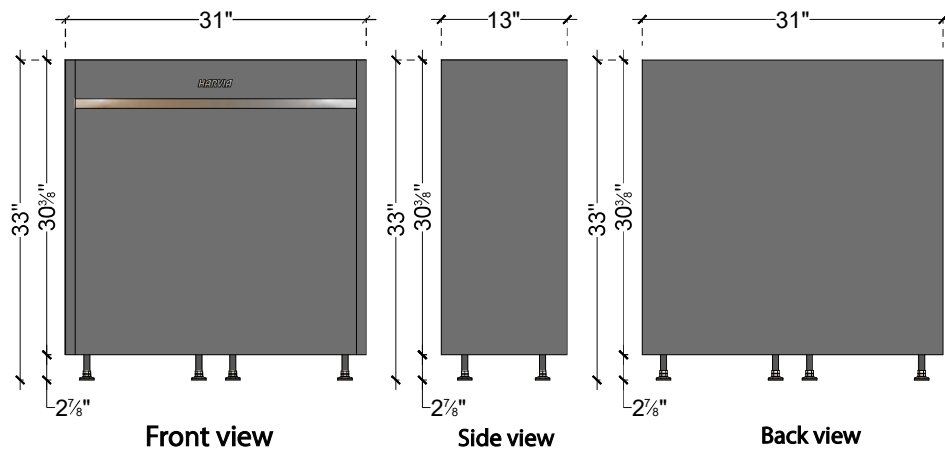

### CODES/STANDARDS



ETL LISTED  
CONFORMS TO  
UL STD 875  
CERTIFIED TO  
CAN/CSA STD  
E60335-2-53-05

### HARVIA® MADE IN FINLAND Limited Warranty

3 year residential  
(use limited)

1 year commercial  
(use limited)



### AVAILABLE COLOR

Color	Description
■	Black

### ACCESSORIES

- Bucket with ladle.
- Sauna fragrances.
- Rocks. (200 Lb.)
- Safety railing.
- Control panel Xenio.
- Power extension unit.
- Control unit.

Product weight: 92.6 Lb.

### CONTROL PANEL XENIO AND POWER UNIT

The control panel can be installed inside or outside the sauna room. If it's installed inside the sauna, the control panel should be 20 inches away from the heater, not higher than 36 inches, and away from possible splashes. The power unit should be installed outside the sauna room in the vicinity of the control panel.

### INSTALLATION REQUIREMENTS

- Sauna heater.
- Control panel Xenio.
- Sensor.
- Power unit and extension power box.
- Venting is required for the sauna to operate properly. (Low vent in under sauna heater and a high vent out on opposite wall.)

# HARVIA

**HARVIA VIRTA 16 KW  
FLOOR-STANDING SAUNA HEATER  
CONTROL PANEL  
VIRTA-160-240**



## SPARE PARTS

- Heating element 2650W/240V
- Hi-limit
- Temperature sensor
- Adjusting leg M10x60

## VOLTAGE AND SAUNA VOLUME

Voltage	Breaker size		Wire size AWG		Sauna volume min. cu. ft.	Sauna volume max. cu. ft.	Control unit	
	2- Separate electric circuits	4- Separate electric circuits	2- Separate electric circuits	4- Separate electric circuits			2- Separate electric circuits	4- Separate electric circuits
240 V 1-PH	2 pole 40 Amps.	4 Pole 30 Amps.	2X8	4X12	354	918	LTY45-U1-U3	LTY45-U1-U3

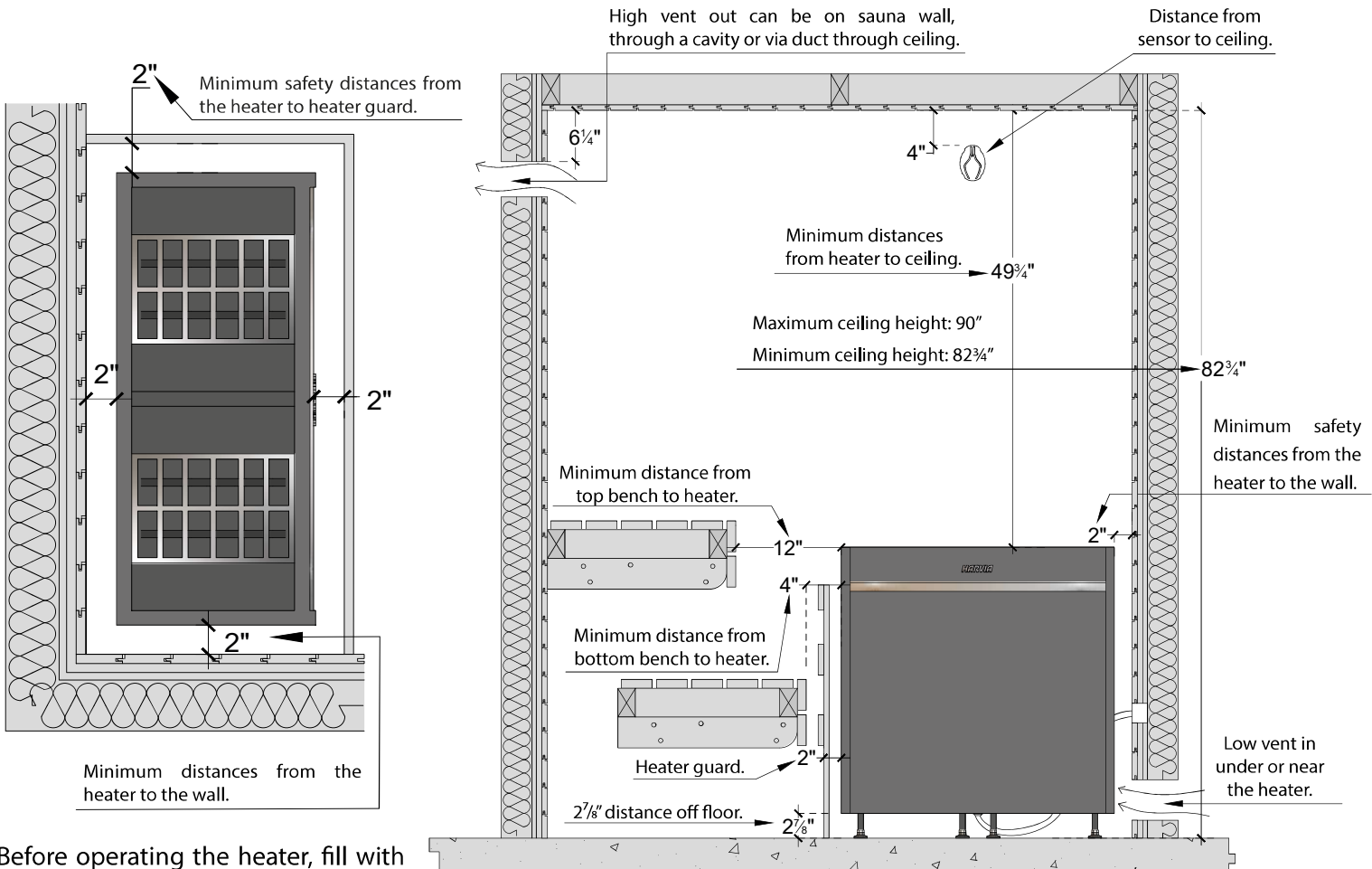

Before operating the heater, fill with rocks and install the safety grid.